

- Grocery
- Residential
- Senior Affordable Residential
- Parking/ Loading/MEP

Note:  
Standard Spaces:  
(Unmarked)  
9' x 19'

Compact Spaces:  
(Marked with C)  
8' x 16'

Accessible Spaces  
(Marked with Accessible  
Symbol)  
9'x 19' Not including  
accessible aisle.

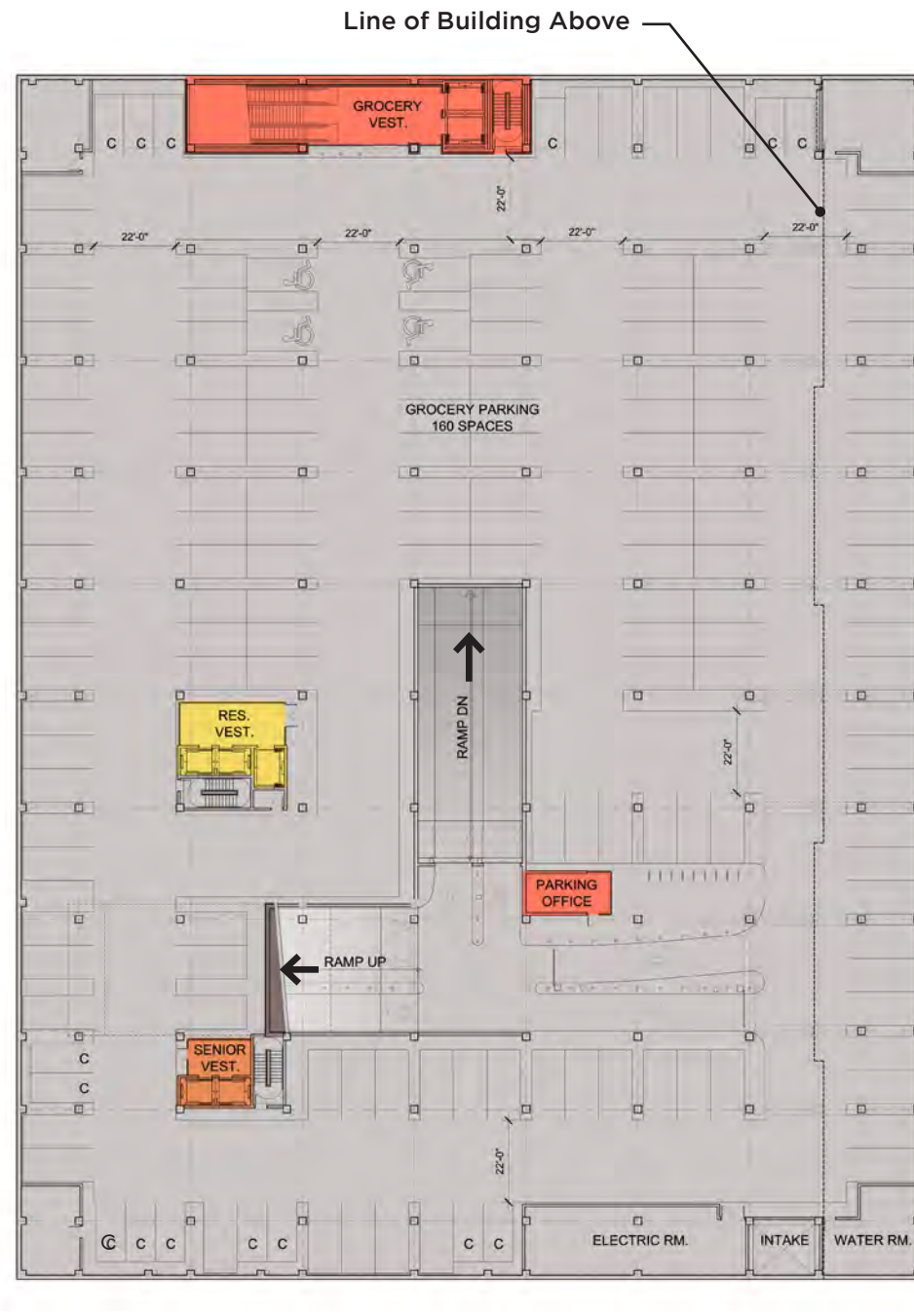

P1 PLAN - RETAIL PARKING

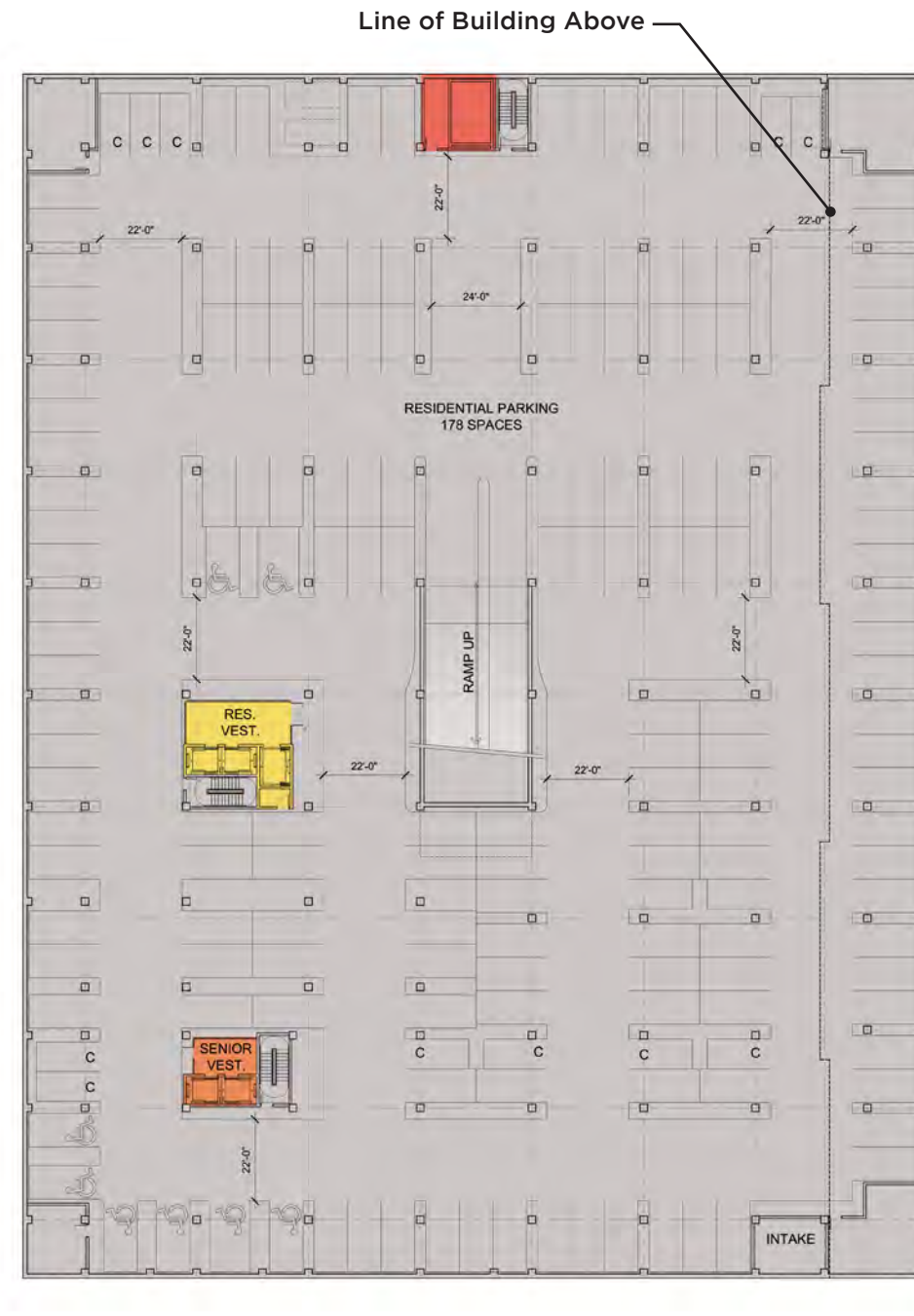

P2 PLAN - RESIDENTIAL PARKING

- Grocery
- Residential
- Senior Affordable Residential
- Parking/ Loading/MEP
- Retail doors to be coordinated with future tenant



STREET LEVEL PLAN

- Residential
- Senior Affordable Residential
- Parking/ Loading/MEP



LEVEL 2 PLAN



LEVELS 3-6 PLAN

- Residential
- Senior Affordable Residential
- Parking/ Loading/MEP

Elevator over-run less than 4'-0" above parapet height



ROOF PLAN